

STANLEY BOSTITCH

Model E Staplers

INSTRUCTIONS FOR OPERATION AND MAINTENANCE

▲ WARNING:

OPERATOR AND OTHERS IN THE WORK AREA SHOULD ALWAYS WEAR SAFETY EYE PROTECTION WHEN TOOLS ARE IN USE.

DO NOT PLACE HANDS BETWEEN STAPLER HEAD AND CLINCHER WHEN OPERATING MACHINE. CARE SHOULD BE TAKEN WHEN REMOVING FACE PLATES AS SUPPORTER IS HELD IN PLACE ONLY BY LUGS ON FACE PLATES, AND WILL BE EJECTED WITH CONSIDERABLE FORCE.

STANDARD E STAPLERS

Catalog Numbers

| | |
|-----------|-----------|
| EHFS82MD | EHA82MC |
| ELFS82MD | EHA82MCMD |
| EHT82MC | EHA83SC |
| EHT82MCMD | EHA83SCMD |
| EHT83SC | EHFS82 |
| EHA87SC | EHFS82FR |
| EHA82MCFR | |

LOADING:

Pull back feed spring until it is released from pusher. Let spring rest against feed spring case, and remove pusher from rear end of core. Slide one or two strips of Stanley-Bostitch staples of proper size on to core, and replace pusher and feed spring. Head is now ready for use.

▲ **WARNING:** Do not place hands between stapler head and clincher when operating machine.

LUBRICATION:

Any machine will work easier and wear longer if kept clean and properly oiled. Stanley-Bostitch staplers should be oiled frequently but sparingly. A drop of oil applied from the point of a toothpick in channel for driver, on plunger spring, in hole in front of supporter, and on core pivot pin will insure easy and trouble-free operation.

CLOGGED STAPLES:

If in some way staples have become clogged, they can be removed by pressing supporter back and forcing staples out of groove. Be sure wire grooves are free from broken pieces of wire.

CLINCHER ADJUSTMENT:

On Arm Type machines (Models EHA, & EHT), loosen clincher plate screw and adjust clincher with slide adjusting screws. Then tighten clincher plate screws.

On all other types, simply loosen the clincher binder screw, adjust clincher by hand, and tighten binder screw.

MOVABLE CLINCHER MAINTENANCE:

It is particularly important to keep the clincher plates clean. Dust and small pieces of material may get into this mechanism and hamper its action. Do not put oil into the clincher plates as this tends to hold the dust.

The front and back plates are held together by studs fastened to the back plate, and fitted snugly into holes in front plate. When clincher is opened, clincher slide and clincher points can be removed. Replacement may be necessary in case of long or hard usage.

TO REMOVE PLUNGER ASSEMBLY:

Detach feed spring from pusher and remove unused staples. Insert thin screw driver under back of driver stop, and pry forward. Plunger

is left free to be removed, and will be forced up by plunger spring unless spring is broken. Plunger spring and driver are then easily removed, cleaned, or replaced.

TO REMOVE FACE PLATES:

Remove plunger as noted above, both upper and lower face plate bolts, also any parts attached by means of lower face plate bolt such as face plate shield. Pry apart gently — the face plates will come off and feed spring assembly can be lifted out. To replace face plates, simply reverse this operation.

IMPORTANT: — Face plate bolts should be brought up tight to avoid play in head.

▲ **WARNING:** Care should be taken when removing face plates as supporter is held in place only by lugs on face plates, and will be ejected with considerable force.

TO CHANGE OPENING ABOVE CLINCHER:

Adjustment can easily be made by raising or lowering the final treadle stop. If the treadle strikes the floor before finishing the clinch, the stroke can be shortened by adjusting the nuts above and below the driving rod sleeve. It is important that the stroke on these machines be properly adjusted on motor driven models, for if they are set too tight, the motor will stall and throw off the cut-off switch.

TO ADJUST FOR LIGHT OR HEAVY WORK:

Simply move compensating lever spring to upper or lower hole.

TO ADJUST HEAD:

Should the stapler head be changed, adjustment forward or back may be required to bring the staple in line with the clincher. This is accomplished by turning the cone point core adjusting screws at the back of the core.

ORDERING:

These machines use different sizes of staples and make different kinds of clinches. It is important therefore that correct part numbers are used when ordering replacement parts. The charts and lists on the following pages give names and number of parts.

**MODEL E1000 STAPLER HEAD
FOR NARROW CROWN STAPLES
(SEE CHART BELOW)**

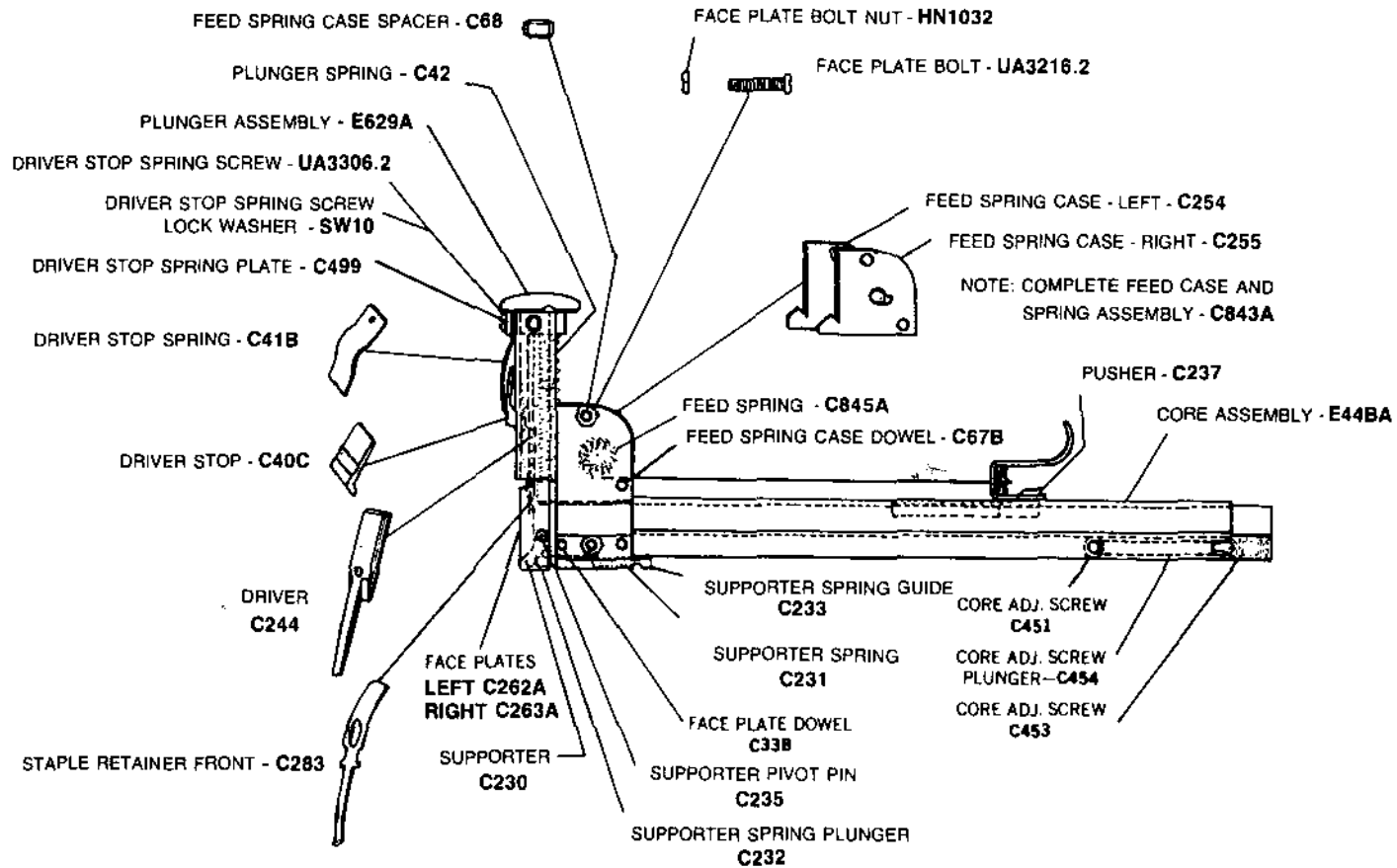

| |
|---|
| <p align="center">E1000BHD</p> <p align="center">SK5019 (1.27mm x .48mm 1/4 (6.6mm) 3/8 (9.5mm))</p> |
|---|

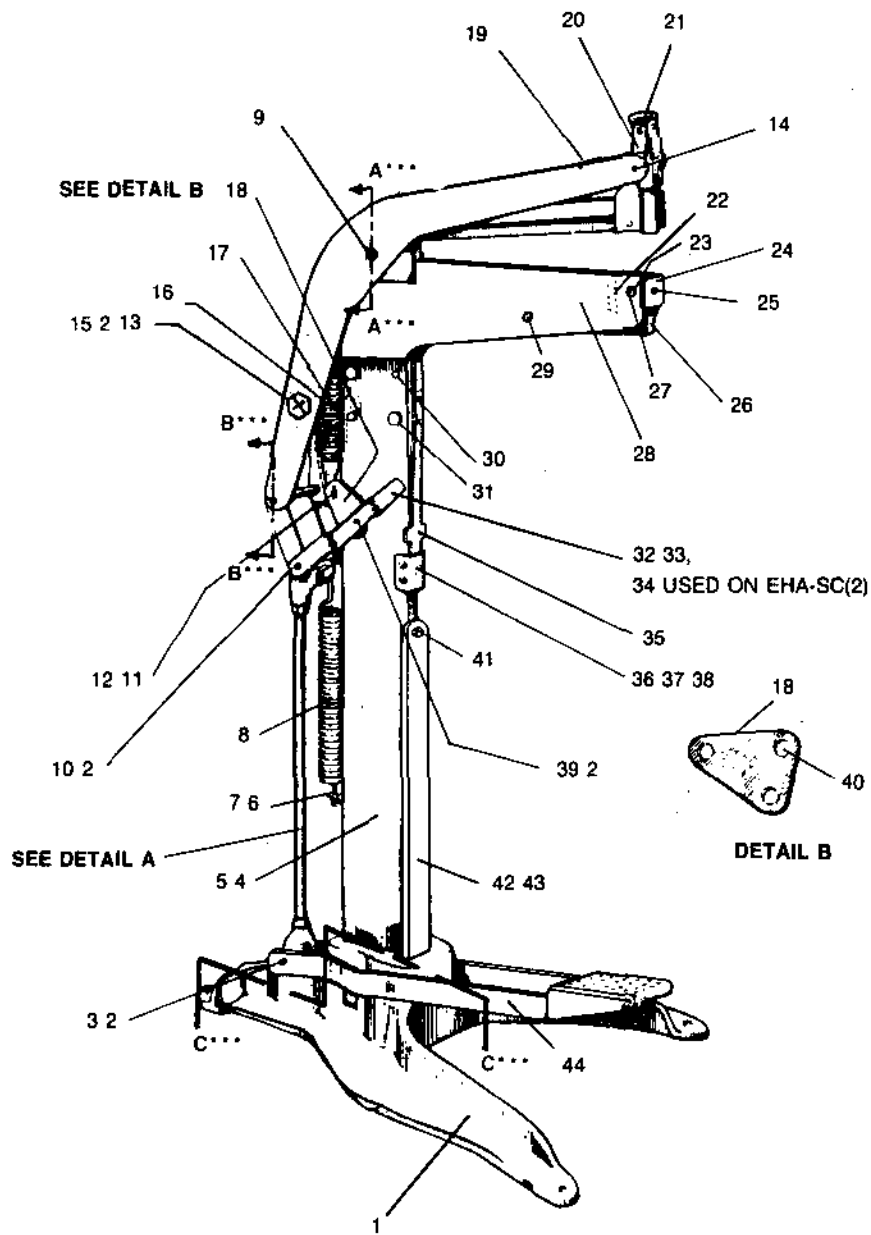

*** See section drawings

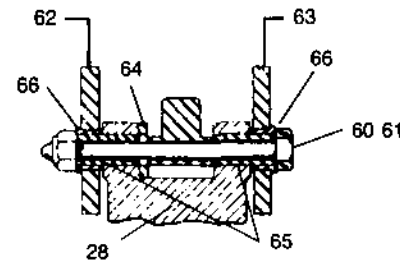
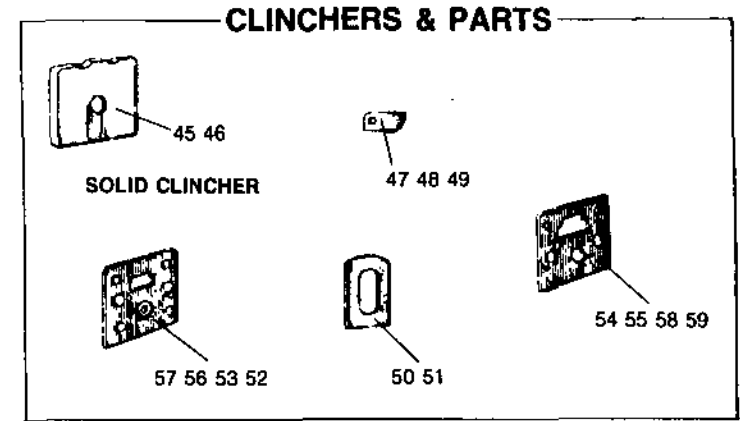

SECTION A-A

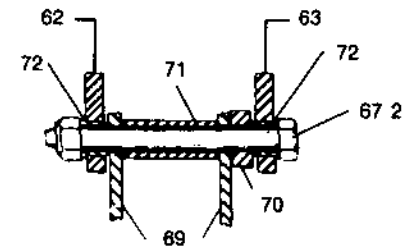

SECTION B-B

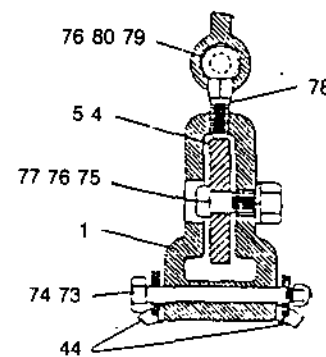

SECTION C-C

NOTE:

- * MOVABLE CLINCHER
- ** MOVABLE CLINCHER SADDLE

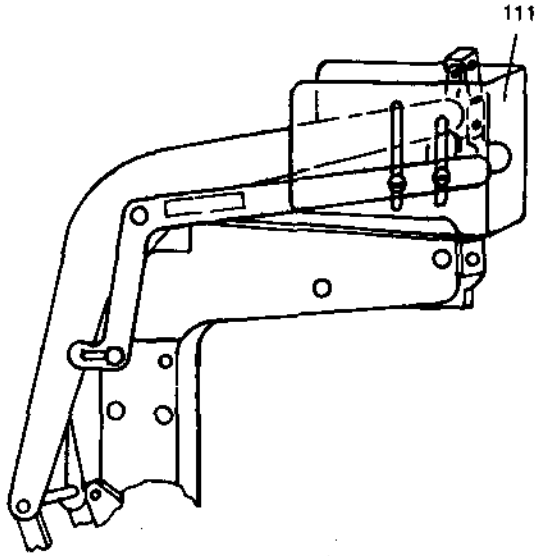

SEE BSA317CS & BSA1399S

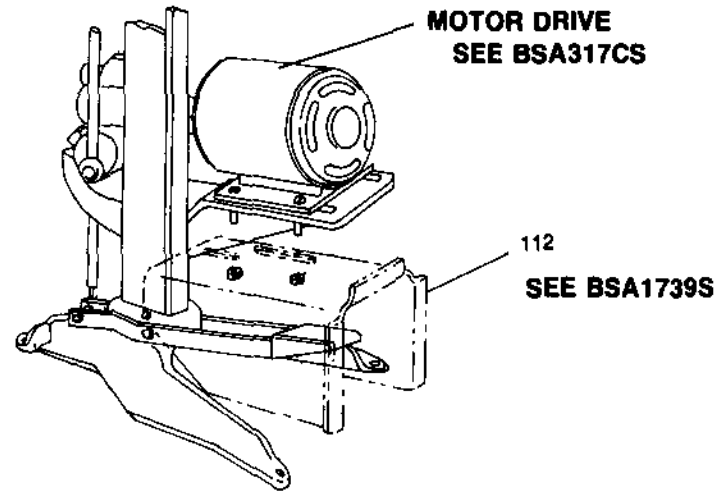

**MOTOR DRIVE
SEE BSA317CS**

**112
SEE BSA1739S**

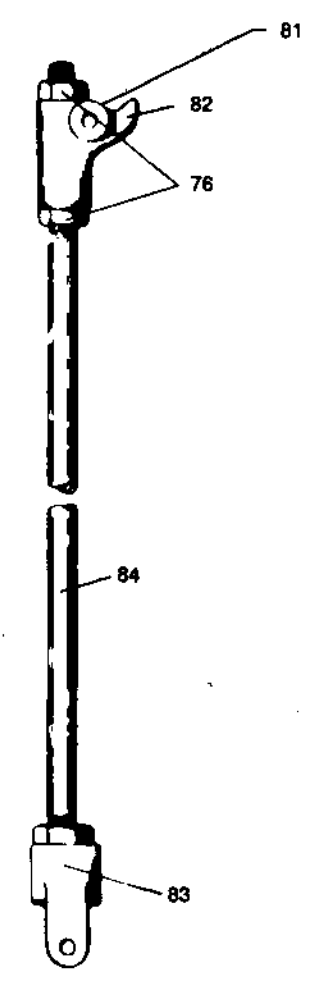

DETAIL A

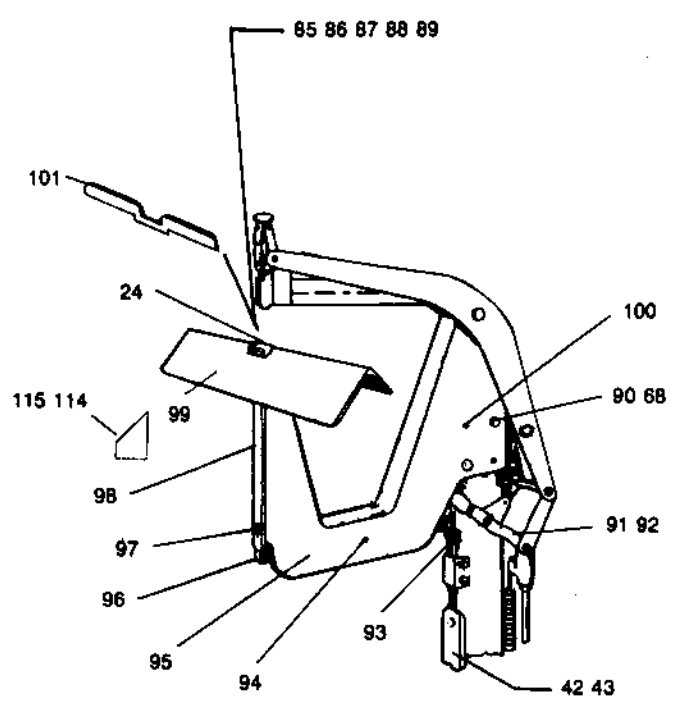

**E SADDLE STAPLER
MODEL EHFS
MODEL ELFS**

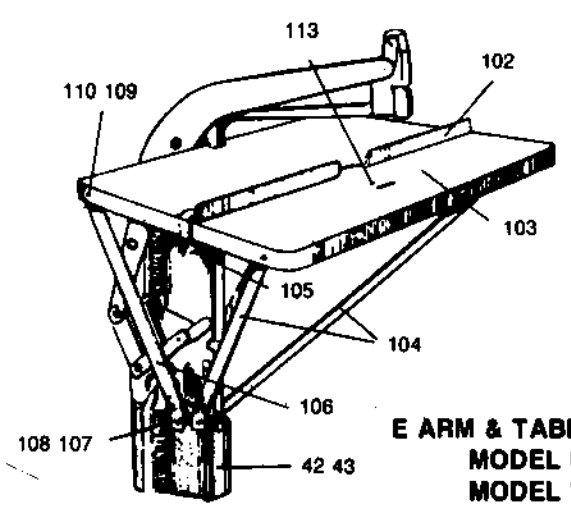

**E ARM & TABLE STAPLER
MODEL EHT-MC
MODEL EHT-SC**

MODEL E8200, E8300, E8600, E8700 STAPLER HEADS FOR SCCR STAPLES (SEE CHART BELOW)

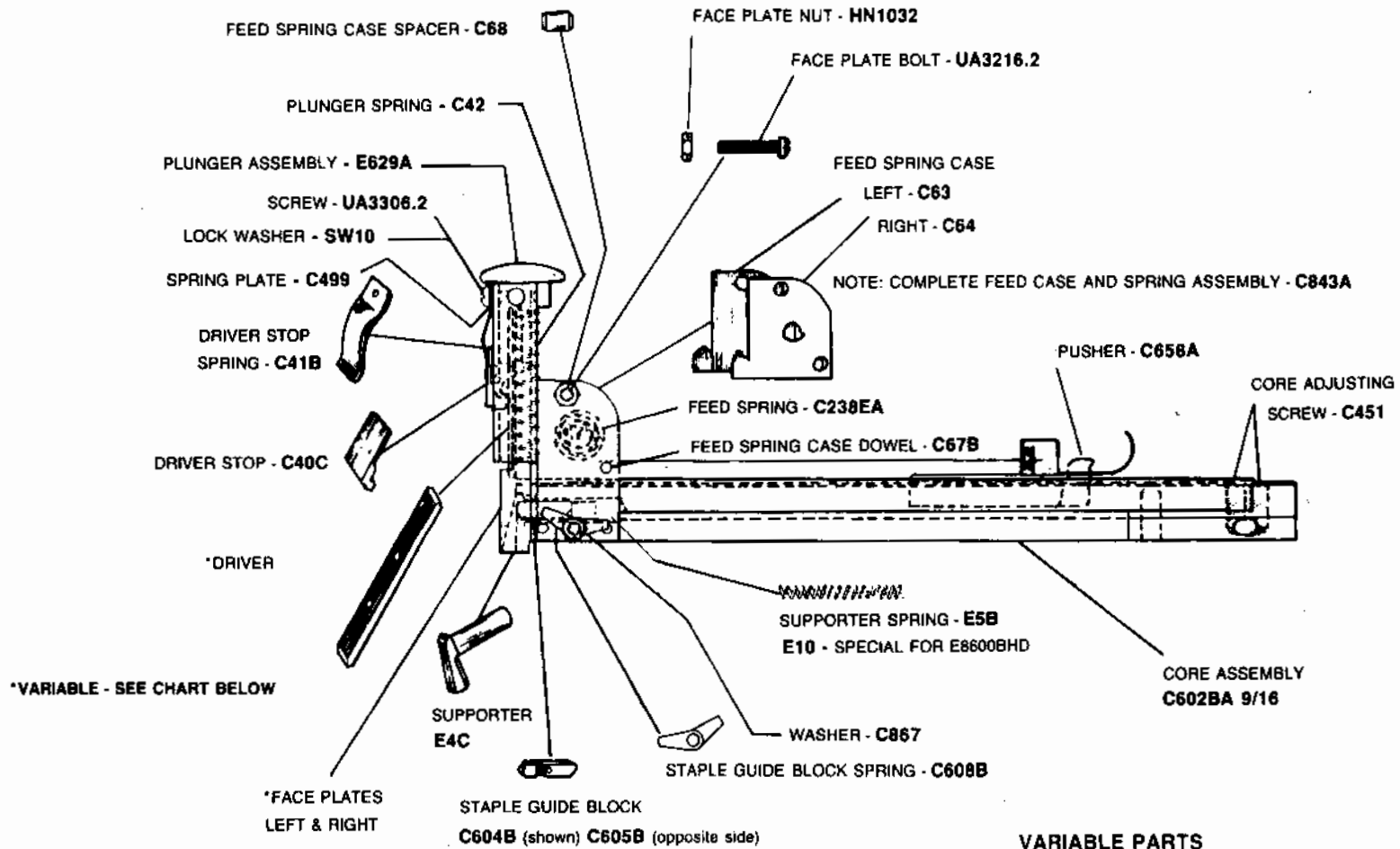

| PART | E8200BHD SCCR .025 (.64mm) | E8300BHD SCCR 5019 (1.27mm x .48mm) | E8600BHD SCCR .019 (.48mm) | E8700BHD SCCR .103 x .020 (2.6mm x .51mm) |
|-------------------|---|---|----------------------------------|---|
| | 1/4 (6.4mm) 3/8 (9.5mm) 1/2 (12.7mm) 9/16 (14.3mm) | 1/4 (6.4mm) 3/8 (9.5mm) 1/2 (12.7mm) 9/16 (14.3mm) | 1/4 (6.4mm) 3/8 (9.5mm) | 1/4 (6.4mm) 3/8 (9.5mm) 1/2 (12.7mm) 9/16 (14.3mm) |
| *DRIVER | C19 | C24 | C29 | C380 |
| *FACE PLATE-LEFT | C8200L | C8300L | C610D | C8700L |
| *FACE PLATE-RIGHT | C8200R | C8300R | C611D | C8700R |

MODEL E STAPLERS PARTS LIST

| ITEM NO. | PART NO. | DESCRIPTION | ITEM NO. | PART NO. | DESCRIPTION | ITEM NO. | PART NO. | DESCRIPTION |
|----------|---------------|--|----------|-------------------|---------------------------------|----------|----------|---------------------------|
| 1 | E105 | BASE | 40 | E182 | COMPENSATING LEVER PIVOT | 79 | UA8136.1 | BOLT |
| 2 | HNS1618.7 | NUT | 41 | UA5112.1 | POST BRACE SCREW | 80 | E133 | SPRING |
| 3 | UA5144.1 | DRIVING ROD YOKE PIN | 42 | E103 | POST BRACE LOW | 81 | E212 | DRIVING ROD SLEEVE COLLAR |
| 4 | E102D | POST HIGH | 43 | E108 | POST BRACE HIGH | 82 | E449 | DRIVING ROD SLEEVE |
| 5 | E101B | POST LOW | 44 | E710A | TREADLE | 83 | E144 | DRIVING ROD YOKE |
| 6 | UA5816.2 | SCREW | 45 | E158 | SOLID CLINCHER FLAT WIRE | 84 | E142 | DRIVING ROD HIGH-POST |
| 7 | HNS1618 | NUT | 46 | E159 | SOLID CLINCHER ROUND WIRE | 85 | E291 | SADDLE TABLE LOCK |
| 8 | E175 | DRIVING ROD SPRING | 47 | C119B | IN-LINE CLINCHER PTS FLAT WIRE | 86 | F141C | CORE PIVOT PART |
| 9 | E15 | CORE LOCK PLATE SCREW | 48 | C120B | IN-LINE CLINCHER PTS ROUND WIRE | 87 | E292 | SADDLE TABLE LOCK SCREW |
| 10 | UA5140.1 | DRIVING ROD SLEEVE PIN | 49 | C96 | PASS-BY CLINCHER PTS ROUND WIRE | 88 | PW10 | PLAIN WASHER |
| *11 | E628 | COMPENSATING LEVER SPRING PIN | 50 | C136 | CLINCHER SLIDE IN-LINE | 89 | E293 | SADDLE TABLE PIVOT |
| 12 | 851561 | RETAINING RING | 51 | C97 | CLINCHER SLIDE PASS-BY | 90 | UA5132.1 | ARM SCREW |
| 13 | E625 | SPACER | *52 | C126A <i>ARM</i> | CLINCHER PLATE W/ STUDS IN-LINE | 91 | E241B | TOGGLE LEVER RIGHT |
| 14 | E169 | DRIVING LEVER LINK BUSHING | *53 | C93CA <i>ARM</i> | CLINCHER PLATE W/ STUDS PASS-BY | 92 | E329 | TOGGLE LEVER LEFT |
| 15 | UA51521 | SCREW | *54 | C127 <i>ARM</i> | CLINCHER PLATE W/ HOLES IN-LINE | 93 | E194BA | SLIDE |
| *16 | E187 | AUXILIARY SPRING 9/16 DIAMETER | *55 | C94 <i>ARM</i> | CLINCHER PLATE W/ HOLES PASS-BY | 94 | E196 | PIVOT |
| *17 | E183B | COMP. LEVER SPRING 1-1/16 DIA. | **56 | C126BA <i>SAD</i> | CLINCHER PLATE W/ STUDS IN-LINE | 95 | E192CA | ARM |
| *18 | E181 | COMPENSATING LEVER | **57 | C93DA <i>SAD</i> | CLINCHER PLATE W/ STUDS PASS-BY | 96 | E147D | LEVER |
| 19 | E165 | DRIVING LEVER SPRING | **58 | C127B <i>SAD</i> | CLINCHER PLATE W/ HOLES IN-LINE | 97 | 0033 | SLIDE SCREW |
| 20 | E161A | DRIVING LINK | **59 | C94B <i>SAD</i> | CLINCHER PLATE W/ HOLES PASS-BY | 98 | C136B | LIFTER |
| 21 | 851378 | RETAINING RING | 60 | UA4156.1 | CORE PIVOT SCREW | 99 | E209 | TABLE |
| *22 | E149 | CLINCHER LEVER SPRING | 61 | HN1420.13 | NUT | 100 | E18B | DOWEL |
| 23 | E195 | SLIDE | 62 | E623A | LEFT HAND DRIVING LEVER | 101 | 0062 | WORK GUIDE |
| 24 | See Item No's | 45,46,47,48,49,50,51,52,53,54,55,56,57,58,59 | 63 | E624A | RIGHT HAND DRIVING LEVER | 102 | E320A | BACK GAUGE |
| 25 | UA3810.1 | CLINCHER PLATE SCREW | 64 | E606 | SPACER | 103 | E301 | TABLE |
| *26 | E147B | CLINCHER LEVER | 65 | F127 | BUSHING | 104 | E306 | FRONT TABLE BRACE |
| 27 | E197 | SCREW | 66 | E12 | DRIVING LEVER PIVOT BUSHING | 105 | E325 | SCREW |
| 28 | E192A | ARM | 67 | UA5152.1 | TOGGLE LINK PIN | 106 | E308 | BACK TABLE BRACE |
| *29 | E196 | CLINCHER LEVER PIVOT | 68 | SW516 | LOCKWASHER | 107 | E314 | BOLT |
| 30 | E18 | DOWEL | 69 | E174B | TOGGLE LINK | 108 | SW516 | WASHER |
| 31 | UA5120.1 | ARM SCREW | 70 | E212 | WASHER | 109 | E311 | BOLT |
| *32 | E177 | TOGGLE LEVER LEFT | 71 | E199 | BUSHING | 110 | SW10 | WASHER |
| *33 | E241B | TOGGLE LEVER RIGHT | 72 | F171 | DRIVING LEVER TOGGLE BUSHING | 111 | EK5 | SAFETY HAND COVER |
| 34 | E211 | TOGGLE LEVER LEFT & RIGHT | 73 | UA6160.1 | TREADLE PIVOT | 112 | EK6 | SAFETY FOOT COVER |
| *35 | E194A | CLINCHER OPERATING SLIDE | 74 | HN3816.7 | NUT | 113 | UA2406.1 | SCREW |
| *36 | E153 | CLINCHER OPERATING SLIDE GUIDE | 75 | E106 | BASE BOLT | 114 | E189 | CLINCHER LOCK NUT |
| *37 | UA5314.1 | SCREW | 76 | HN1213.2 | NUT | 115 | UA3812.2 | CLINCHER SCREW |
| *38 | HN1618.2 | NUT | 77 | LW12.2 | LOCKWASHER | | | |
| 39 | UA5128.1 | TOGGLE LEVER PIVOT | 78 | UA8516.1 | BASE BOLT BINDER SCREW | | | |

LIMITED WARRANTY

Stanley-Bostitch, Inc., warrants to the original retail purchaser that this product is free from defects in material and workmanship, and agrees to repair or replace, at Stanley-Bostitch's option, any defective product within 90 days from the date of purchase. This warranty is not transferable. It only covers damage resulting from defects in material or workmanship, and it does not cover conditions or malfunctions resulting from normal wear, neglect, abuse or accident.

THIS WARRANTY IS IN LIEU OF ALL OTHER EXPRESS WARRANTIES. ANY WARRANTY OF MERCHANTABILITY OR FITNESS FOR A PARTICULAR PURPOSE IS LIMITED TO THE DURATION OF THIS WARRANTY. STANLEY-BOSTITCH SHALL NOT BE LIABLE FOR ANY INCIDENTAL OR CONSEQUENTIAL DAMAGES.

Some states do not allow limitations on how long an implied warranty lasts, or the exclusion or limitation of incidental or consequential damages, so the above limitations or exclusions may not apply to you. This warranty gives you specific legal rights, and you may also have other rights which vary from state to state.

To obtain warranty service, you must return the product at your expense together with proof of purchase to a Stanley-Bostitch Regional warranty repair center listed below or you may call us at 1-800-832-3080 for the location of additional authorized warranty service locations in your area.

EASTERN: Stanley-Bostitch, Inc., 1 Feltloc Lane, East Greenwich, R.I. 02818

MIDWEST: Stanley-Bostitch, Inc., 420 South Kitley Avenue, P.O. Box 19329, Indianapolis, IN 46219

SOUTHERN: Stanley-Bostitch, Inc., 1105 Satellite Blvd. Suite 105, Suwanee, GA 30174

WESTERN: Stanley-Bostitch, Inc., 6941 West Goshen Avenue, P.O. Box 111, Visalia, CA 93277

To find the Stanley-Bostitch service location nearest you, please call:

1-800-832-3080

STANLEY BOSTITCH
Stanley Fastening Systems

BOSTITCH®

INSTRUCTIONS FOR OPERATION AND MAINTENANCE OF MODEL E STAPLERS

WARNING:

OPERATOR AND OTHERS IN THE WORK AREA SHOULD ALWAYS WEAR SAFETY EYE PROTECTION WHEN TOOLS ARE IN USE.

DO NOT PLACE HANDS BETWEEN STAPLER HEAD AND CLINCHER WHEN OPERATING MACHINE. CARE SHOULD BE TAKEN WHEN REMOVING FACE PLATES AS SUPPORTER IS HELD IN PLACE ONLY BY LUGS ON FACE PLATES, AND WILL BE EJECTED WITH CONSIDERABLE FORCE.

LOADING:

Pull back feed spring until it is released from pusher. Let spring rest against feed spring case, and remove pusher from rear end of core. Slide one or two strips of Bostitch staples of proper size onto core, and replace pusher and feed spring. Head is now ready for use.

WARNING: Do not place hands between stapler head and clincher when operating machine.

LUBRICATION:

Machine will work easier and wear longer if kept clean and properly oiled. Bostitch staplers should be oiled frequently but sparingly. A drop of oil applied from the point of a toothpick in channel for driver, on plunger spring, in hole in front of supporter, and on core pivot pin will insure easy and trouble-free operation.

CLOGGED STAPLES:

If in some way staples have become clogged, they can be removed by pressing supporter back and forcing staples out of groove. Be sure wire grooves are free from broken pieces of wire.

CLINCHER ADJUSTMENT:

On Arm Type machines (Models EHA, & EHT), loosen clincher plate screw and adjust clincher with slide adjusting screws. Then tighten clincher plate screws.

On all other types, simply loosen the clincher binder screw, adjust clincher by hand, and tighten binder screw.

MOVABLE CLINCHER MAINTENANCE:

It is particularly important to keep the clincher plates clean. Dust and small pieces of material may get into this mechanism and hamper its action. Do not put oil into the clincher plates as this tends to hold the dust.

The front and back plates are held together by studs fastened to the back plate, and fitted snugly into holes in front plate. When clincher is opened, clincher slide and clincher points can be removed. Replacement may be necessary in case of long or hard usage.

TO REMOVE PLUNGER ASSEMBLY:

Detach feed spring from pusher and remove unused staples. Insert narrow driver under back of driver stop, and pry forward. Plunger

is left free to be removed, and will be forced up by plunger spring unless spring is broken. Plunger spring and driver are then easily removed, cleaned, or replaced.

TO REMOVE FACE PLATES:

Remove plunger as noted above, both upper and lower face plate bolts, also any parts attached by means of lower face plate bolt such as face plate shield. Pry apart gently — the face plates will come off and feed spring assembly can be lifted out. To replace face plates, simply reverse this operation.

IMPORTANT: — Face plate bolts should be brought up tight to avoid play in head.

WARNING: Care should be taken when removing face plates as supporter is held in place only by lugs on face plates, and will be ejected with considerable force.

TO CHANGE OPENING ABOVE CLINCHER:

Adjustment can easily be made by raising or lowering the final treadle stop. If the treadle strikes the floor before finishing the clinch, the stroke can be shortened by adjusting the nuts above and below the driving rod sleeve. It is important that the stroke on these machines be properly adjusted on motor driven models, for if they are set too tight, the motor will stall and throw off the cut-off switch.

TO ADJUST FOR LIGHT OR HEAVY WORK:

Simply move compensating lever spring to upper or lower hole.

TO ADJUST HEAD:

Should the stapler head be changed, adjustment forward or back may be required to bring the staple in line with the clincher. This is accomplished by turning the cone point core adjusting screws at the back of the core.

ORDERING:

These machines use different sizes of staples and make different kinds of clinches. It is important therefore that correct part numbers are used when ordering replacement parts. The charts and lists on the following pages give names and number of parts.

MODEL E STAPLER HEADS FOR SCCR STAPLES

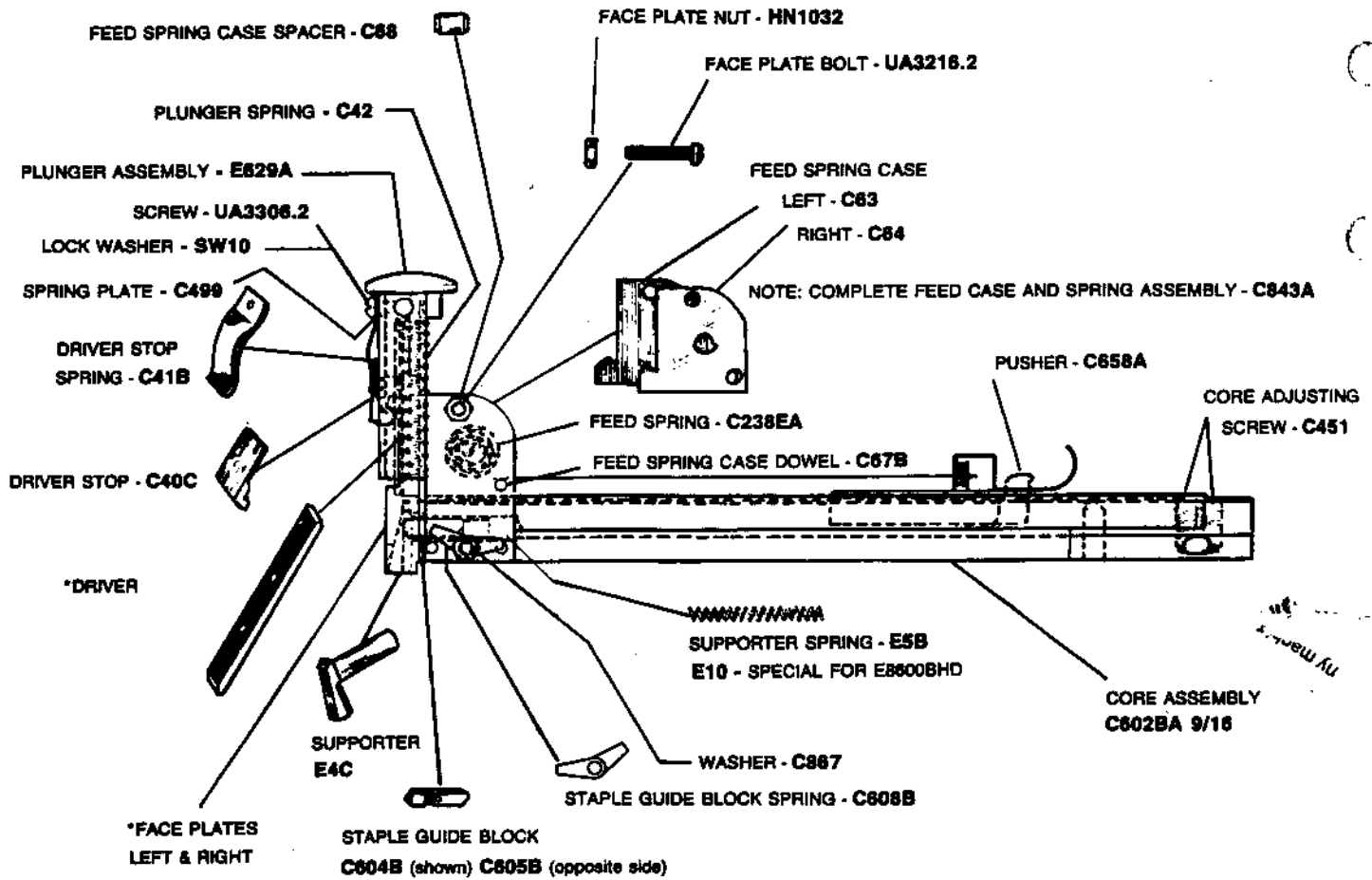

*VARIABLE - SEE CHART BELOW

VARIABLE PARTS

| | <i>6200 6400</i> E8200BHD SCCR .025 (.64mm) | <i>6300 6500</i> E8300BHD SCCR 5019 (1.27mm x .48mm) | <i>6600 7800</i> E8600BHD SCCR .019 (.48mm) | <i>6700 6900 9200 9300</i> E8700BHD SCCR .103 x .020 (2.6mm x .51mm) |
|-------------------------|---|---|--|--|
| PART | 1/4 (6.4mm) 3/8 (9.5mm) 1/2 (12.7mm) 9/16 (14.3mm) | 1/4 (6.4mm) 3/8 (9.5mm) 1/2 (12.7mm) 9/16 (14.3mm) | 1/4 (6.4mm) 3/8 (9.5mm) | 1/4 (6.4mm) 3/8 (9.5mm) 1/2 (12.7mm) 9/16 (14.3mm) |
| DRIVER | C19 | C24 | C29 | C380 |
| FACE PLATE-LEFT | C8200L | C8300L | C610D | C8700L |
| FACE PLATE-RIGHT | C8200R | C8300R | C611D | C8700R |

MODEL E STAPLER HEADS - FOR NARROW CROWN STAPLES

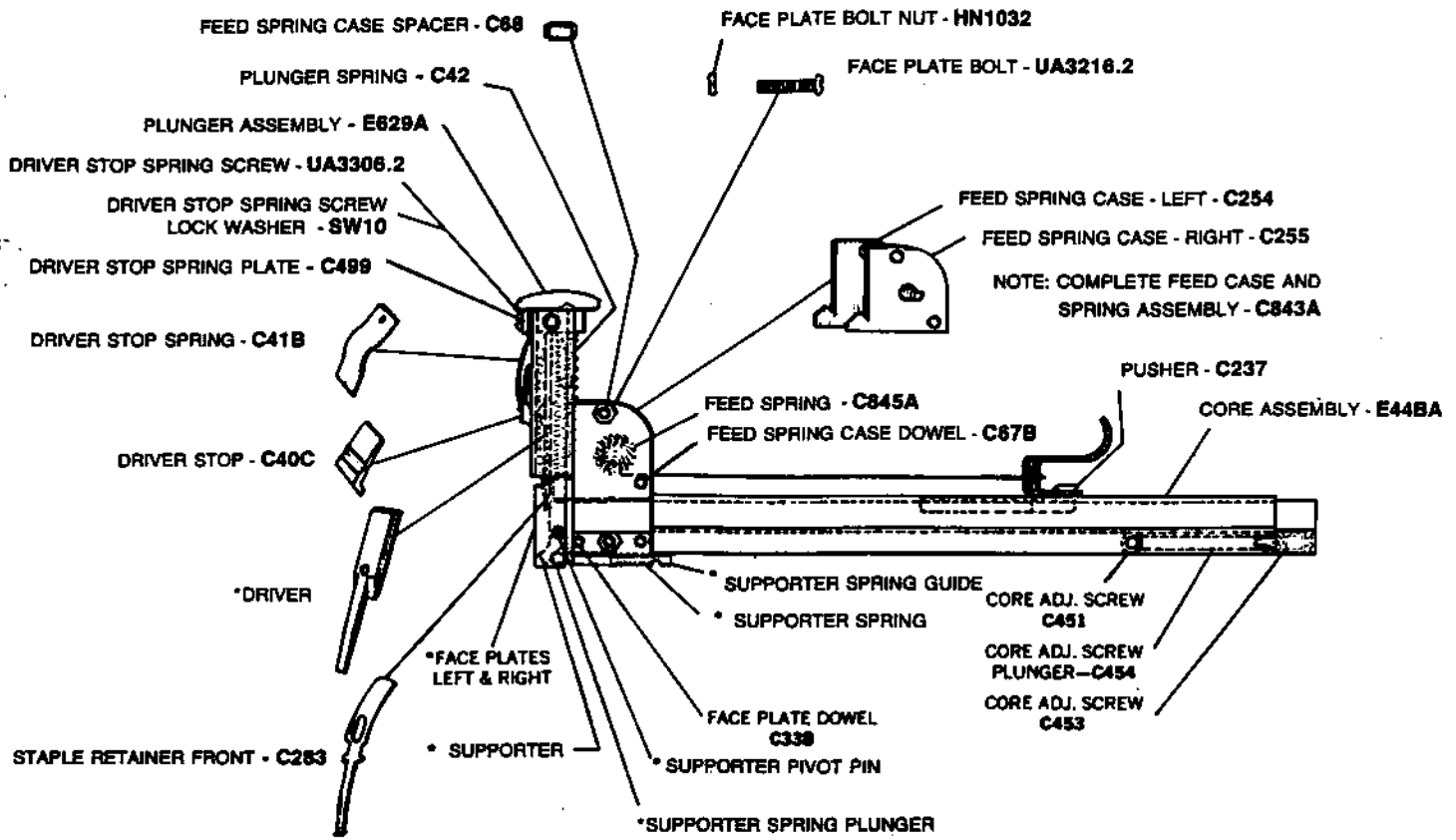

DIAGRAM SHOWS E800B HEAD

VARIABLE PARTS

| PART | E1000BHD SK5019 3/8 (9.5mm) | E4600BHD SK5019 3/8 (9.5mm) | E4800BHD SK19 1/4; 3/8 (6.4mm; 9.5mm) |
|-----------------------------|-----------------------------------|-----------------------------------|---|
| FACE PLATE-LEFT | C262A | C512A | C596A |
| FACE PLATE-RIGHT | C263A | C513A | C597A |
| DRIVER | C244 | C244 | C227B |
| SUPPORTER | C230 | NONE | C230 |
| SUPPORTER SPRING | C231 | NONE | C231 |
| SUPPORTER SPRING PLUNGER | C232 | NONE | C232 |
| SUPPORTER SPRING GUIDE | C233 | NONE | C233 |
| SUPPORTER PIVOT PIN | C235 | NONE | C235 |

1000BHD

4600BHD

F9400ECHD SERIES WIDE CROWN STAPLING HEAD FOR SW9043 7/16, 5/8, 3/4, 7/8 STAPLES

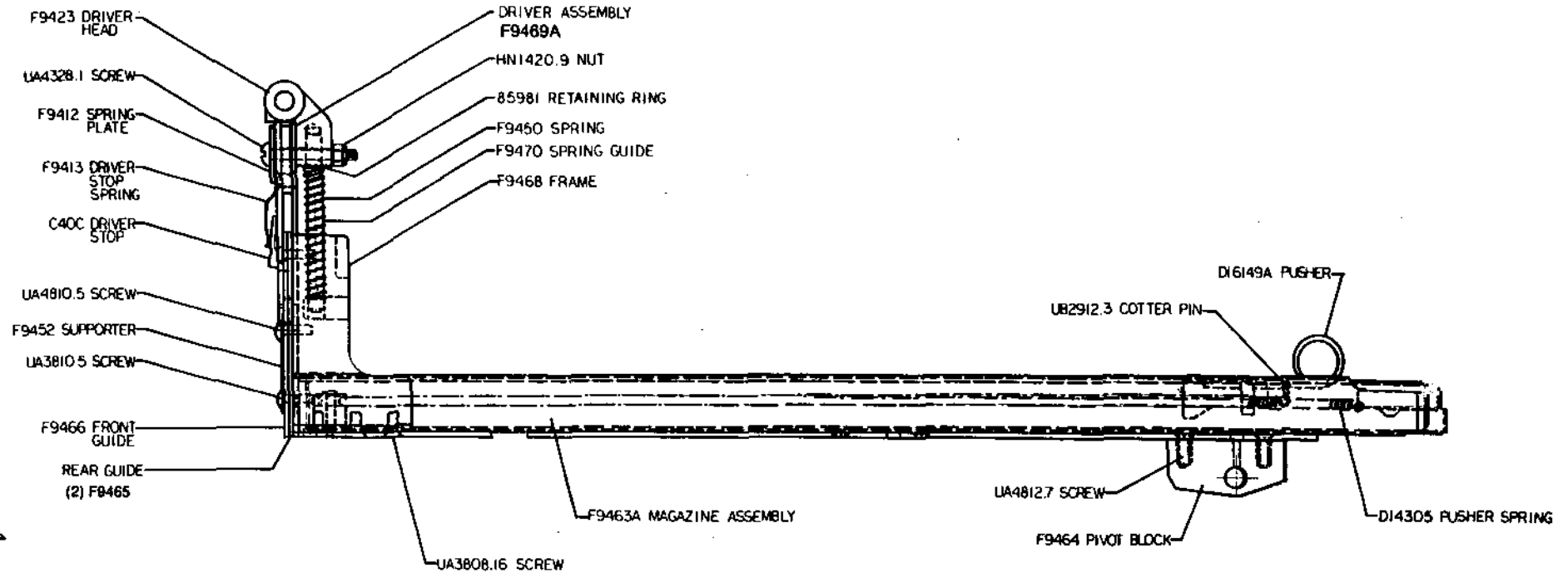

MACHINE PARTS SPECIAL TO MODEL E94HA (see diagram on page 5)

| PART | DESCRIPTION | PART | DESCRIPTION |
|-------|--|----------|------------------------------|
| E99 | NUT-DRIVING LEVER | C957N | DRIVER HEAD PIN |
| F173 | SPACER (short) DRIVING LEVER | F9426A | DRIVING LINK |
| E179B | SPACER-TOGGLE LINK | C957M | PIVOT PIN ADAPTER |
| E211 | TOGGLE LINK | F9440A | DRIVING LEVER-LEFT |
| E212 | TOGGLE LINK PIN COLLAR | F9441A | DRIVING LEVER-RIGHT |
| E604 | CLINCHER | F9443 | SPACER (long) DRIVING LEVER |
| E614 | SPACER-ADAPTER PIVOT PIN | UA5156.2 | SCREW-DRIVING LEVER-TOGGLE |
| EK3 | SPECIAL TO ORDER FLAT TYPE CLINCHER (FC95 type clincher) | 851562 | RETAINING RING (pivot pin) |
| | | 85017 | RETAINING RING (driver head) |

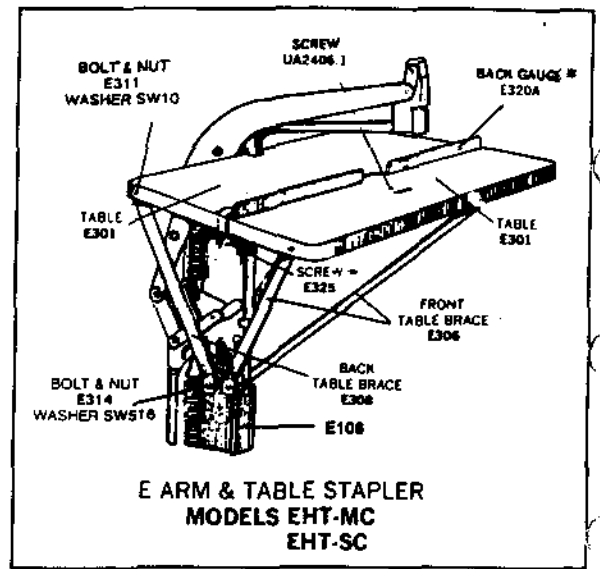
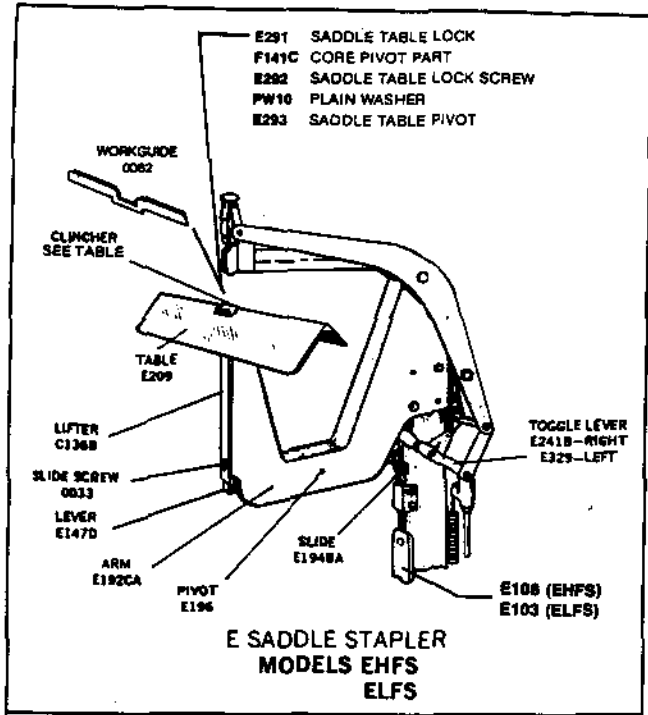

*SPECIAL TO ORDER ITEMS

NOTE: SEE PAGE 5 FOR PARTS NOT LISTED ON THIS PAGE.

THE FOLLOWING PARTS ARE NOT SHOWN IN DIAGRAMS:

| | | | |
|------|---------------------------------|----------|-------------------------------|
| E12 | Driving Lever Pivot Bushing | F171 | Driving Lever Toggle Bushing |
| E15 | Core Lock Plate Screw | LW12.2 | Lock Washer — Base Bolt |
| E18B | Arm Locating Dowel (Saddle Arm) | SW10 | Lock Washer — Cl. Plate Screw |
| E106 | Base Bolt | SW516 | Lock Washer — Arr.: Screw |
| E169 | Driving Lever Link Bushing | UA5132.1 | Arm Screw (Saddle Arm) |
| E182 | Compensating Lever Pivot | UA8516.1 | Binder Screw — Base Bolt |
| E189 | Clincher Lock Nut (Saddle Arm) | | |
| E249 | Clincher Screw | | |

| STANDARD E STAPLERS | | |
|---------------------|-----------|-----------------------|
| CATALOG NUMBER | HEAD | CLINCHER PARTS |
| EHA82MC | E8200BHD | C93CA, C96, C97, C94 |
| EHA82MCMD | E8200BHD | C93CA, C96, C97, C94 |
| EHA83SC | E8300BHD | E158 |
| EHA83SCMD | E8300BHD | E158 |
| EHFS82 | E8200BHD | C93DA, C96, C97, C94B |
| EHFS82MD | E8200BHD | C93DA, C96, C97, C94B |
| ELFS82MD | E8200BHD | C93DA, C96, C97, C94B |
| EHT82MC | E8200BHD | C93CA, C96, C97, C94 |
| EHT82MCMD | E8200BHD | C93CA, C96, C97, C94 |
| EHT83SC | E8300BHD | E158 |
| EHT83SCMD | E8300BHD | E158 |
| E94HA | F9400ECHD | E804 (solid) |

LIMITED WARRANTY

Stanley-Bostitch, Inc., warrants to the original retail purchaser that this product is free from defects in material and workmanship, and agrees to repair or replace, at Bostitch's option, any defective product within 90 days from the date of purchase. This warranty is not transferable. It only covers damage resulting from defects in material or workmanship, and it does not cover conditions or malfunctions resulting from normal wear, neglect, abuse or accident.

THIS WARRANTY IS IN LIEU OF ALL OTHER EXPRESS WARRANTIES. ANY WARRANTY OF MERCHANTABILITY OR FITNESS FOR A PARTICULAR PURPOSE IS LIMITED TO THE DURATION OF THIS WARRANTY. BOSTITCH SHALL NOT BE LIABLE FOR ANY INCIDENTAL OR CONSEQUENTIAL DAMAGES.

Some states do not allow limitations on how long an implied warranty lasts, or the exclusion or limitation of incidental or consequential damages, so the above limitations or exclusions may not apply to you. This warranty gives you specific legal rights, and you may also have other rights which vary from state to state.

To obtain warranty service, you must return the product at your expense together with proof of purchase to your nearest Bostitch office, check your telephone directory or write to your nearest Bostitch Regional office; the four Bostitch Regional Offices in the United States are:

EASTERN: Stanley-Bostitch, Inc., 1 Feltloc Lane, East Greenwich, R.I. 02818

MIDWEST: Stanley-Bostitch, Inc., 420 South Kitley Avenue, P.O. Box 19329, Indianapolis, IN 46219

SOUTHERN: Stanley-Bostitch, Inc., 3623 Clearview Parkway, Atlanta, GA 30340

WESTERN: Stanley-Bostitch, Inc., 6941 West Goshen Avenue, P.O. Box 111, Visalia, CA 93277

BOSTITCH SERVICE LOCATIONS & WAREHOUSES

| | | |
|---|--|--|
| ARIZONA Phoenix 602-257-8043† | KENTUCKY Somerset 606-679-6842 | OHIO Cleveland 216-433-1060 Cincinnati 513-825-7771 |
| CALIFORNIA Fullerton* 714-773-5592† Visalia* 209-851-4011† | LOUISIANA New Orleans 504-764-1533 | PENNSYLVANIA Philadelphia 215-643-6201† |
| COLORADO Denver* 303-373-4874† | MASSACHUSETTS Woburn 617-933-1157† | PUERTO RICO* 809-781-6216 |
| FLORIDA Ft. Lauderdale* 305-979-5710 Tampa* 813-621-4791 | MICHIGAN Detroit 313-669-0805 Grand Rapids 616-452-1435 | RHODE ISLAND East Greenwich* 401-885-0700† |
| GEORGIA Atlanta* 404-458-2324 | MINNESOTA Minneapolis 612-835-2440 | TENNESSEE Memphis 901-365-7200 |
| HAWAII Honolulu* 808-836-4568 | MISSOURI St. Louis 314-567-6120 | TEXAS Dallas* 214-620-8770 Houston 713-240-3697 |
| ILLINOIS Skokie 312-470-8400 | NEW JERSEY Pine Brook 201-575-8996† | UTAH Salt Lake City 801-984-6097† |
| INDIANA Indianapolis* 317-353-2171 | NEW YORK Syracuse 315-437-0237† | VIRGINIA Richmond 804-222-3106† |
| KANSAS Kansas City 913-894-1066 | NORTH CAROLINA Charlotte 704-376-4402 High Point 919-887-4055 | WASHINGTON Seattle 206-575-0656† |

*Denotes Warehousing Locations

†Use this number for REPAIR SERVICE only. For customer service in Construction, Mass Market and Graphic Arts Industries call TOLLFREE 1-800-558-8696, all others call 1-800-832-3080.

STANLEY BOSTITCH

A Subsidiary of The Stanley Works